



ALLEN & SHEPPARD.



44 Elouera Road Westleigh NSW

4 3 2

In an ideal Westleigh location stands this versatile single level family full brick home. Boasting 4 large bedrooms, two with ensuite's, multiple living areas and a long list of extras making this home a must to inspect. The options this floorplan creates are endless making the home ideal for family's looking for extra space to have 3 generations in one home, a teenage retreat or those just wanting room to get away. The home is wrapped around the in-ground pool creating a relaxing water view from a number of rooms and the front courtyard is a great place to enjoy the sun.

Price : \$ 1,115,000

View : <https://www.allenandsheppard.com.au/sale/nsw/hills/westleigh/residential/house/6204735>

The long list of extras include:

- ? 10kw solar system and a solar heated pool.
- ? Open fireplace, Reverse Cycle A/C and hide away fans in each room.
- ? A newly renovated Ensuite plus two other bathrooms.
- ? Large eat in kitchen with level lawn at the rear.



James Sheppard
02 9481 9000



Craig Taylor
02 9481 9000

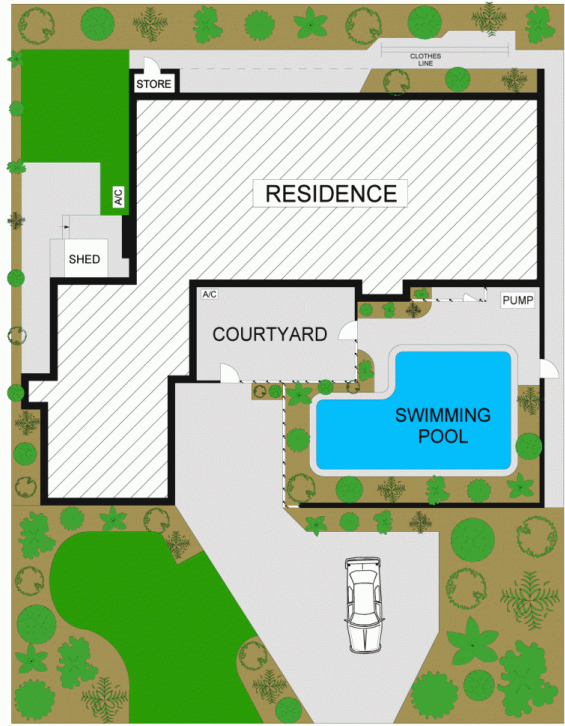

Dimensions are approximate. All information contained is gathered from sources we believe to be reliable. However we cannot guarantee its accuracy and interested persons should rely on their own enquiries.
www.visionphoto.com.au

44 ELOUERA ROAD, WESTLEIGH
 APPROX. INTERNAL FLOOR AREA: 174 SQM

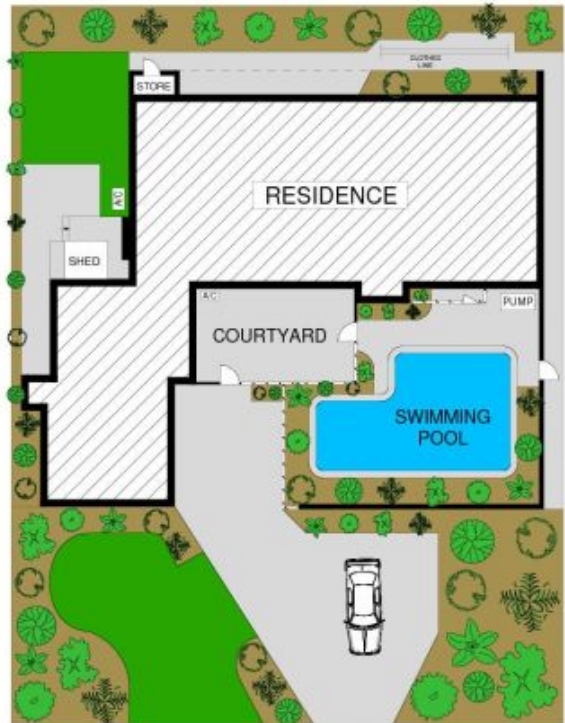

Dimensions are approximate. All information contained is gathered from sources we believe to be reliable. However we cannot guarantee its accuracy and interested persons should rely on their own enquiries.
www.visionphoto.com.au

44 ELOUERA ROAD, WESTLEIGH
 APPROX. INTERNAL FLOOR AREA: 174 SQM

